

YAKI HOLE

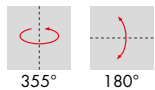

48V IP20

Codice	CCT	Flusso lm	Potenza	Dimensioni mm
YAK013XX	3000K	1600	13W	Ø95 x 167 x 88

ottica intercambiabile:
MT.HOL12 (12°)

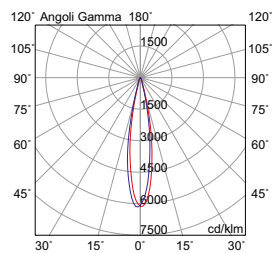
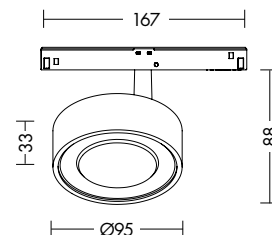

Finiture



YAKI LINEARE

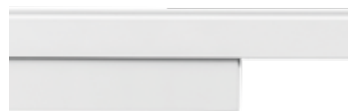

48V IP20

Codice	CCT	Flusso lm	Potenza	Dimensioni mm
YAK001XX	3000K	1470	13W	565 x 22 x 25
YAK002XX	4000K	1550	13W	565 x 22 x 25

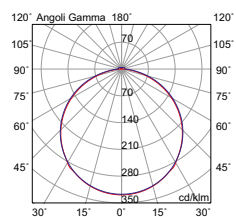
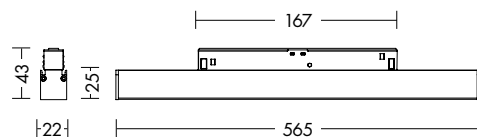

Finiture

